

Technical Data Sheet

CODE 42209

MPC-E 302 M

Medium-pressure long cased axial fans



Certifications

CE CE

EAC EAC

TECHNICAL AND PERFORMANCE DATA

Frequency (Hz)	50	Number of poles	2
Insulation class	I°	Voltage (V)	230
IP	X4	Weight (Kg)	12,3
Max absorbed current (A)	1,80	Max airflow (l/s)	792
Max absorbed power (W)	375	Max airflow (m³/h)	2850
Max ambient temperature for continuous operation (°C)	70	Max pressure (mmH2O)	60,0
Min continuous operation room temperature (°C)	-25	Max pressure (Pa)	588
Nominal diameter (mm)	300	RPM	2940
Number of phases (Ph)	1	Sound power Lw [dB(A)]	79.9
		Sound pressure Lp [dB (A)] at 3 m	59.4

DIMENSIONS

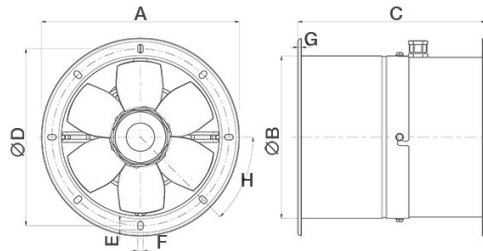

Size A (mm)	∅ 393
Size B (mm)	∅ 316
Size C (mm)	330
Size D (mm)	∅ 366
Size E (mm)	14
Size F (mm)	9
Size G (mm)	4
Size H (mm)	45°

PER INFORMAZIONI / FOR INFORMATION

ITALY

Pre Sales:

prevendita@vortice-italy.com

After Sales:

postvendita@vortice-italy.com

UNITED KINGDOM & REP. OF

IRELAND

Sales Dept:

sales@vortice.ltd.uk

Technical Dept:

technical@vortice.ltd.uk

OTHER COUNTRIES

Sales Dept:

export@vortice-italy.com

After Sales:

after-sales@vortice-italy.com

Technical Data Sheet

CODE 42209

MPC-E 302 M

Medium-pressure long cased axial fans



DESCRIPTION

- Nominal diameter 300 mm
- 2 rolled steel flange sections, welded, phosphated and polyester powder coated in practical grey colour with hammered effect finish, guaranteeing long-term resistance to atmospheric agents.
- 1 speed single phase AC motor with shaft turning in double shielded ball bearings, insulation class F.
- Maximum air flow: 2,860 m³/h.
- Impeller with 6 wing profile blades, dynamically balanced (UNI ISO 1940 – Balancing class 6.3), optimized to deliver maximum performance and low noise levels, moulded from filled polypropylene for superior dimensional stability and resistance to atmospheric agents, and keyed to a diecast aluminium hub.
- Vortice speed controller.

CURVES

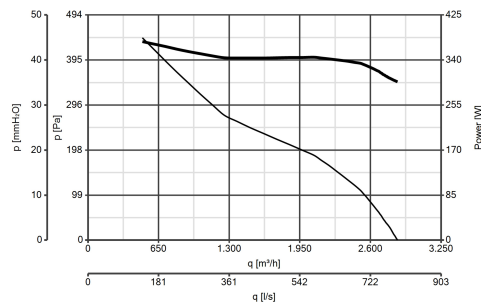

ACCESSORIES



IREM 5 CD
99250081

Code 12932

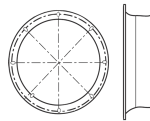

MPC BO 300
(BOCCAGLIO)

Code 22536

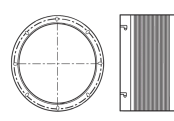

MPC RA 300
(RACCORDO FLESSIBILE)

Code 22517

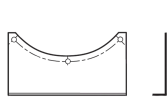

MPC SU 300
(SUPPORTO)

Code 22532

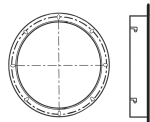

MPC FL 300
(FLANGIA)

Code 22524

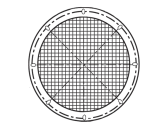

MPC RP 300
(RETE DI PROTEZIONE)

Code 22528



IRM 40

Code 12922

PER INFORMAZIONI / FOR INFORMATION

ITALY
Pre Sales:
prevendita@vortice-italy.com
After Sales:
postvendita@vortice-italy.com

UNITED KINGDOM & REP. OF IRELAND
Sales Dept:
sales@vortice.ltd.uk
Technical Dept:
technical@vortice.ltd.uk

OTHER COUNTRIES
Sales Dept:
export@vortice-italy.com
After Sales:
after-sales@vortice-italy.com