

# Technical Data Sheet

CODE 42228

## MPC-E 404 M

Medium-pressure long cased axial fans



### Certifications

CE CE

EAC EAC

### TECHNICAL AND PERFORMANCE DATA

Frequency (Hz)	50	Number of poles	4
Insulation class	I°	Voltage (V)	220-240
IP	X4	Weight (Kg)	14,0
Max absorbed current (A)	1,30	Max airflow (l/s)	1333
Max absorbed power (W)	272	Max airflow (m³/h)	4800
Max ambient temperature for continuous operation (°C)	70	Max pressure (mmH2O)	18.7
Min continuous operation room temperature (°C)	-25	Max pressure (Pa)	183
Nominal diameter (mm)	400	RPM	1440
Number of phases (Ph)	1	Sound power Lw [dB(A)]	68.6
		Sound pressure Lp [dB (A)] at 3 m	48.1

### DIMENSIONS

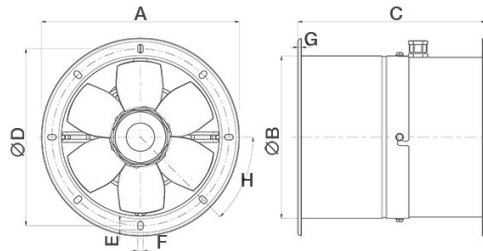

Size A (mm)	ø 475
Size B (mm)	ø 418
Size C (mm)	330
Size D (mm)	ø 448
Size E (mm)	14
Size F (mm)	9
Size G (mm)	4
Size H (mm)	45°

### PER INFORMAZIONI / FOR INFORMATION

#### ITALY

Pre Sales:

prevendita@vortice-italy.com

After Sales:

postvendita@vortice-italy.com

#### UNITED KINGDOM & REP. OF

IRELAND

Sales Dept:

sales@vortice.ltd.uk

Technical Dept:

technical@vortice.ltd.uk

#### OTHER COUNTRIES

Sales Dept:

export@vortice-italy.com

After Sales:

after-sales@vortice-italy.com

# Technical Data Sheet

CODE 42228

## MPC-E 404 M

Medium-pressure long cased axial fans



### DESCRIPTION

- Nominal diameter 400 mm
- 2 rolled steel flange sections, welded, phosphated and polyester powder coated in practical grey colour with hammered effect finish, guaranteeing long-term resistance to atmospheric agents.
- 1 speed single phase AC motor with shaft turning in double shielded ball bearings, insulation class F.
- Maximum air flow: 5.000 m<sup>3</sup>/h.
- Impeller with 6 wing profile blades, dynamically balanced (UNI ISO 1940 – Balancing class 6.3), optimized to deliver maximum performance and low noise levels, moulded from filled polypropylene for superior dimensional stability and resistance to atmospheric agents, and keyed to a diecast aluminium hub.
- Vortice speed controller.

### CURVES

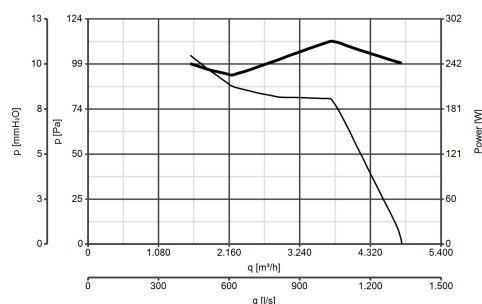

### ACCESSORIES



#### IREM 3 CD 99250080

Code 12931

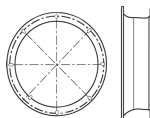

#### MPC BO 400 (BOCCAGLIO)

Code 22538

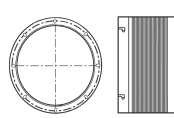

#### MPC RA 400 (RACCORDO FLESSIBILE)

Code 22519



#### MPC SU 400 (SUPPORTO)

Code 22534

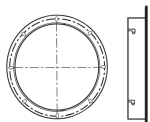

#### MPC FL 400 (FLANGIA)

Code 22526

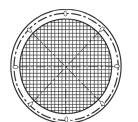

#### MPC RP 400 (RETE DI PROTEZIONE)

Code 22520



#### IRM 40

Code 12922

### PER INFORMAZIONI / FOR INFORMATION

#### ITALY

Pre Sales:  
prevendita@vortice-italy.com  
After Sales:  
postvendita@vortice-italy.com

#### UNITED KINGDOM & REP. OF

IRELAND  
Sales Dept:  
sales@vortice.ltd.uk  
Technical Dept:  
technical@vortice.ltd.uk

#### OTHER COUNTRIES

Sales Dept:  
export@vortice-italy.com  
After Sales:  
after-sales@vortice-italy.com