

# Technical Data Sheet

CODE 42310

## MPC-E 304 T

Medium-pressure long cased axial fans



### Certifications

CE CE

EAC EAC

### TECHNICAL AND PERFORMANCE DATA

Frequency (Hz)	50	Number of poles	4
Insulation class	I°	Voltage (V)	400
IP	X4	Weight (Kg)	10,2
Max absorbed current (A)	0,24	Max airflow (l/s)	625
Max absorbed power (W)	107	Max airflow (m³/h)	2250
Max ambient temperature for continuous operation (°C)	70	Max pressure (mmH2O)	10,4
Min continuous operation room temperature (°C)	-25	Max pressure (Pa)	102
Motor ATEX marking	55	RPM	1400
Nominal diameter (mm)	300	Sound power Lw [dB(A)]	55,3
Number of phases (Ph)	3	Sound pressure Lp [dB (A)] at 3 m	34,8

### DIMENSIONS

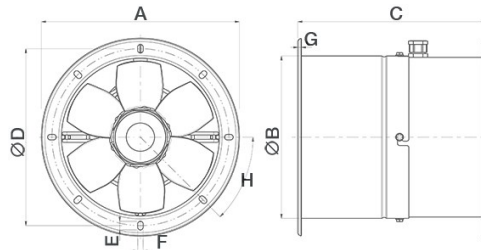

Size A (mm)	∅ 393
Size B (mm)	∅ 316
Size C (mm)	330
Size D (mm)	∅ 366
Size E (mm)	14
Size F (mm)	9
Size G (mm)	4
Size H (mm)	45°

### PER INFORMAZIONI / FOR INFORMATION

#### ITALY

Pre Sales:

prevendita@vortice-italy.com

After Sales:

postvendita@vortice-italy.com

#### UNITED KINGDOM & REP. OF

IRELAND

Sales Dept:

sales@vortice.ltd.uk

Technical Dept:

technical@vortice.ltd.uk

#### OTHER COUNTRIES

Sales Dept:

export@vortice-italy.com

After Sales:

after-sales@vortice-italy.com

# Technical Data Sheet

CODE 42310

## MPC-E 304 T

Medium-pressure long cased axial fans



### DESCRIPTION

- Nominal diameter 300 mm
- 2 rolled steel flange sections, welded, phosphated and polyester powder coated in practical grey colour with hammered effect finish, guaranteeing long-term resistance to atmospheric agents.
- 1 speed three-phase AC motor with shaft turning in double shielded ball bearings, insulation class F.
- Maximum air flow: 2,250 m<sup>3</sup>/h.
- Impeller with 6 wing profile blades, dynamically balanced (UNI ISO 1940 – Balancing class 6.3), optimized to deliver maximum performance and low noise levels, moulded from filled polypropylene for superior dimensional stability and resistance to atmospheric agents, and keyed to a diecast aluminium hub.
- Vortice speed controller.

### CURVES

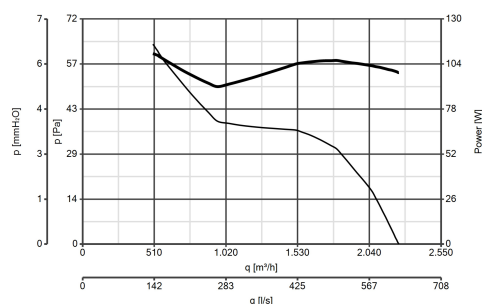

### ACCESSORIES



**IRT 15**  
Code 12923



**IRET 6**  
Code 12934

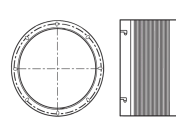

**MPC RA 300  
(RACCORDO  
FLESSIBILE)**  
Code 22517



**MPC SU 300  
(SUPPORTO)**  
Code 22532

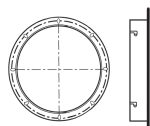

**MPC FL 300  
(FLANGIA)**  
Code 22524

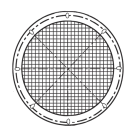

**MPC RP 300  
(RETE DI  
PROTEZIONE)**  
Code 22528

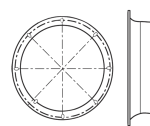

**MPC BO 300  
(BOCCAGLIO)**  
Code 22536

### PER INFORMAZIONI / FOR INFORMATION

ITALY  
Pre Sales:  
prevendita@vortice-italy.com  
After Sales:  
postvendita@vortice-italy.com

UNITED KINGDOM & REP. OF  
IRELAND  
Sales Dept:  
sales@vortice.ltd.uk  
Technical Dept:  
technical@vortice.ltd.uk

OTHER COUNTRIES  
Sales Dept:  
export@vortice-italy.com  
After Sales:  
after-sales@vortice-italy.com